

**Shower and shower accessories**  
**51689010100 Arm for head shower DN 15**

**PRODUCT**

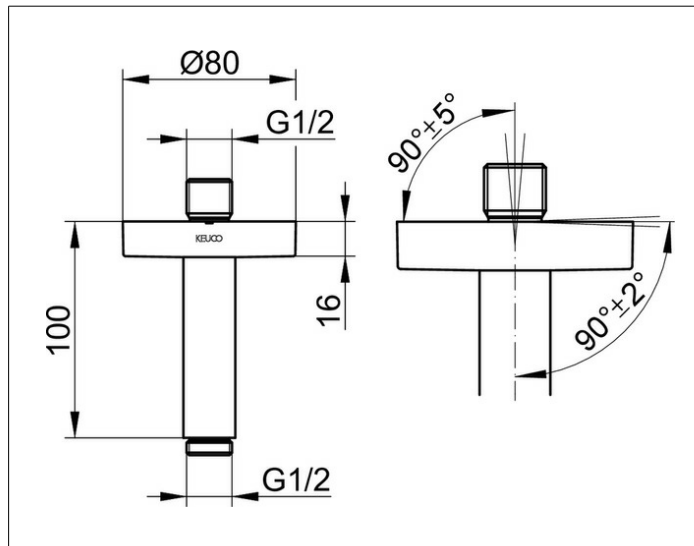

**DRAWING**



**PRODUCT ATTRIBUTES**

ceiling mounted G 1/2, with round decorative disc  
 Opportunity of alignment to the ceiling ( $90^\circ \pm 2^\circ$ ) and  
 ceiling connection ( $90^\circ \pm 5^\circ$ )

**SURFACE**

chrome-plated

**DIMENSION**

100 mm

**SPECIFICATIONS**

KEUCO ELEGANCE Shower holder for ceiling 51689010100  
 chrome plated shower holder for ceiling,  
 G 1/2 inch, with round wall element, diameter 60 mm,  
 Projection: 100 mm